

PROPRIETARY INFORMATION
COMPANY CONFIDENTIAL

REV. X1	ECN. NO.	DESCRIPTION INITIAL	ENG TERRY	DATE 05/31/18'
---------	----------	------------------------	--------------	-------------------

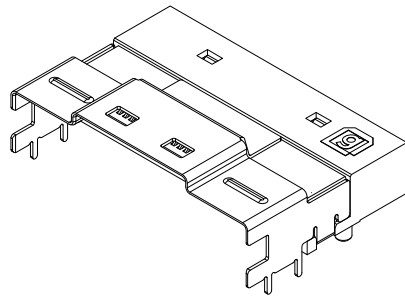
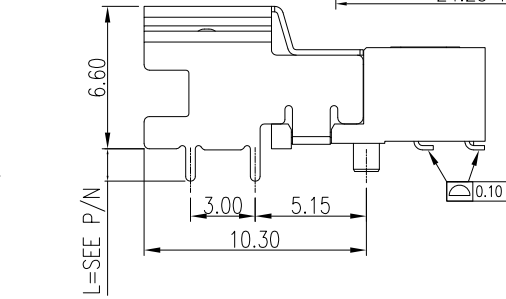
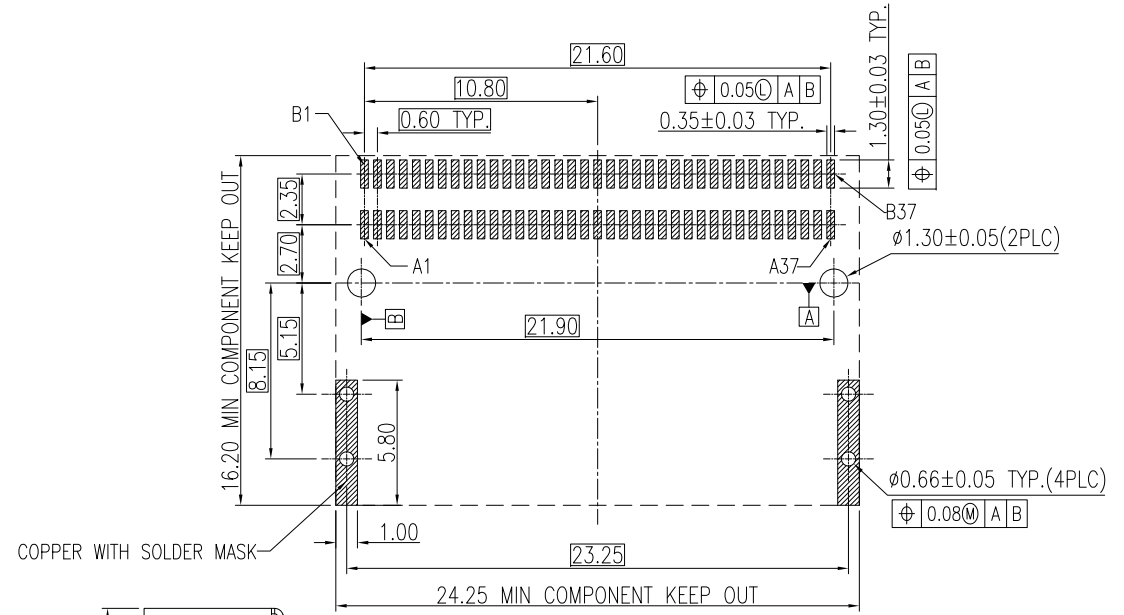
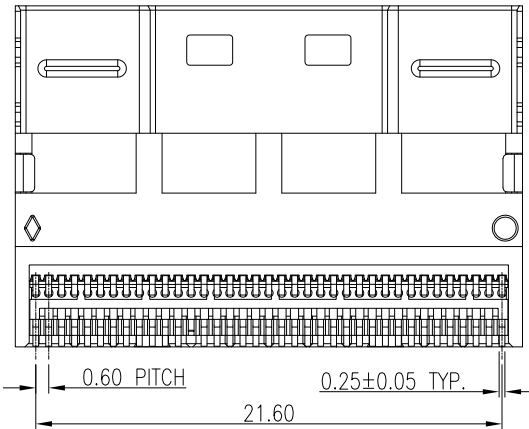
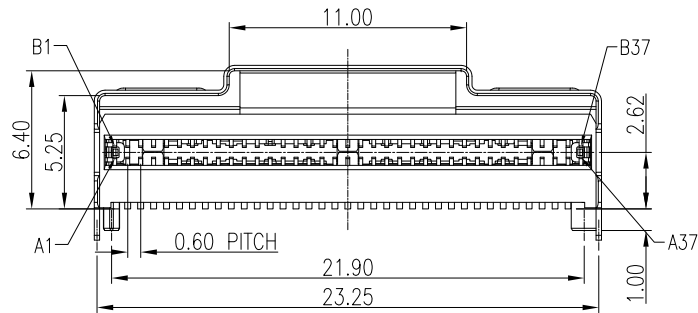
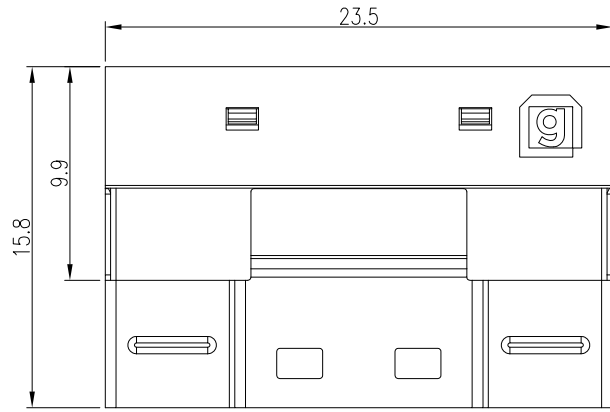

NOTES:
MATERIAL:

- 1: HOUSING: SOLDER REFLOW PROCESS COMPATIBLE LCP, UL94V-0
- CONTACTS: HIGH PERFORMANCE COPPER ALLOY
- SHELL: SUS
- 2: ROHS COMPLIANT

PART NUMBER

PART NUMBER	GOLD PLATING	DIM. L
230-10047-01	GOLD 30u"	1.5mm
230-10047-02	GOLD 30u"	2.2mm
230-10047-03	GOLD 30u"	3.0mm
230-10047-04	GOLD 30u"	4.2mm
230-10047-05	GOLD 15u"	1.5mm
230-10047-06	GOLD 15u"	2.2mm
230-10047-07	GOLD 15u"	3.0mm
230-10047-08	GOLD 15u"	4.2mm

GENERAL TOLERANCE X± .X±0.35 .XX±0.25 .XXX±0.15	ANGLE TOLERANCE X°± .X°± .XX°± .XXX°±	DRAWN Terry	DATE 5/31/18'	
MATL SEE BOM	FINISH SEE NOTES	CHECKED	DATE	
SCALE N/A	UNIT mm	APPROVED	DATE	PART NUMBER: 230-10047-XX
SHEET 1 OF 1				DRAWING NO. 230-10047
				SIZE A4
				REV. X1