

PROPRIETARY INFORMATION
COMPANY CONFIDENTIAL

REV.	ECN. NO.	DESCRIPTION	ENG	DATE
A		INITIAL	Knight	03/10/15'

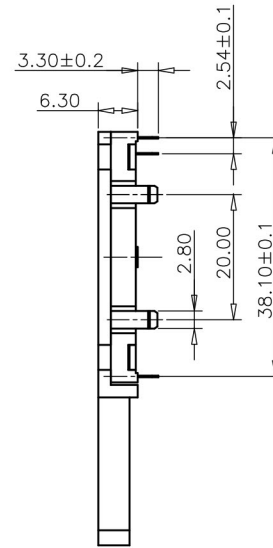
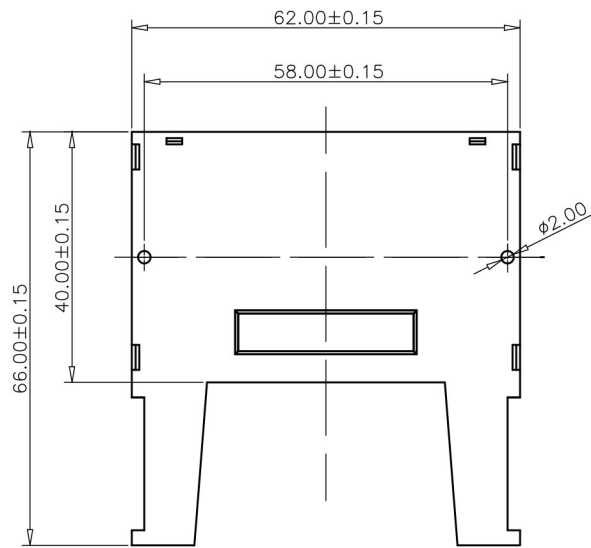

ORDER INFORMATION

SMCR-84 08 - A K H 0 T
① ② ③④⑤⑥⑦

- TYPE:
SMCR-84:SMART CARD CONNECTOR
- POSITIONS:
08:08 POSITIONS
- INSULATOR MATERIAL:
A: PBT
- INSULATOR COLOR:
K: BLACK
- CONTACT PLATING:
H: GOLD 2u"
- SHIELD PLATING:
O: NONE SHIELD
- PACKING
T: TRAY

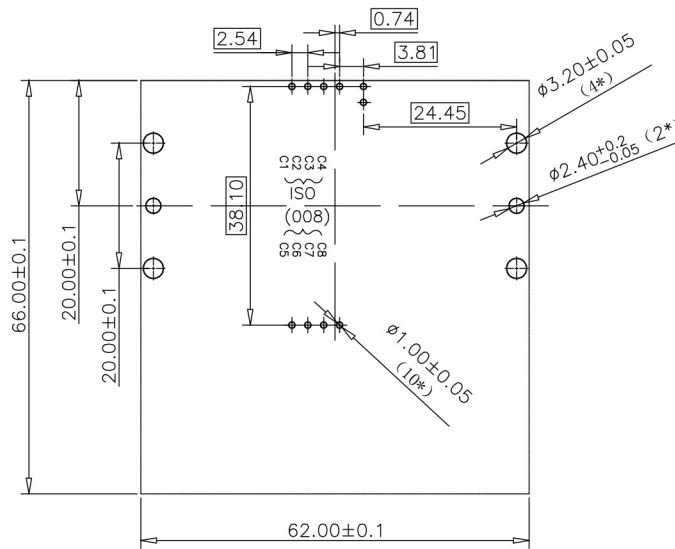
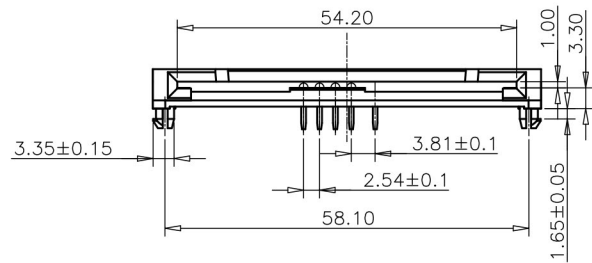

RoHs COMPLIANT

GENERAL TOLERANCE X ± 0.50 .X ± 0.40 .XX ± 0.30 .XXX ± 0.20	ANGLE TOLERANCE X° ± 5.0° .X° ± 3.0° .XX° ± 2.0° .XXX° ± 1.0°	DRAWN <i>knighe</i>	DATE 03/10/15'	 TITLE: SMART CARD CONNECTOR PART NUMBER: SMCR-8408-AKH0T DRAWING NO.: GT26-210427	SIZE A4 REV. A
MATL SEE BOM	FINISH SEE NOTES	CHECKED	DATE		
SCALE N/A	UNIT mm	APPROVED <i>River</i>	DATE 03/10/15'		
SHEET 1 OF 1					

ITEM	NAME	Q'TY	DESCRIPTION	NOTE
3	SWITH	1	PHOSPHOR BRONZE, GOLD 2u" MIN PLATING CONTACT AREA, TIN 80u" MIN PLATING SOLDER AREA, 50u" MIN PLATING UNDER OVERALL	
2	CONTACT	08	PHOSPHOR BRONZE, GOLD 2u" MIN PLATING CONTACT AREA, TIN 80u" MIN PLATING SOLDER AREA, 50u" MIN PLATING UNDER OVERALL	
1	HOUSING	1	PBT	BLACK, UL94 V-0