

PROPRIETARY INFORMATION
COMPANY CONFIDENTIAL

REV	ECN. NO.	DESCRIPTION	ENG	DATE
A		INITIAL	Knight	03/10/15'

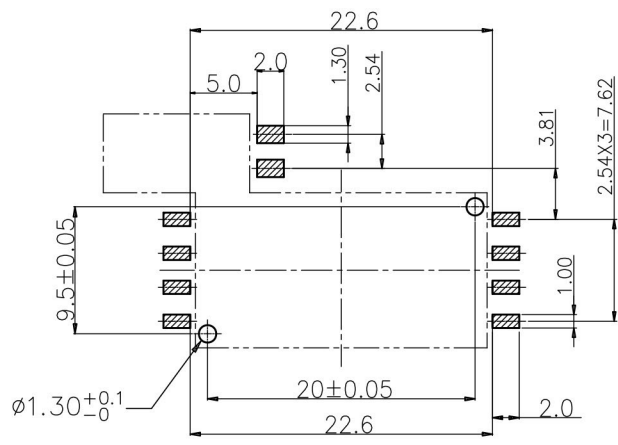
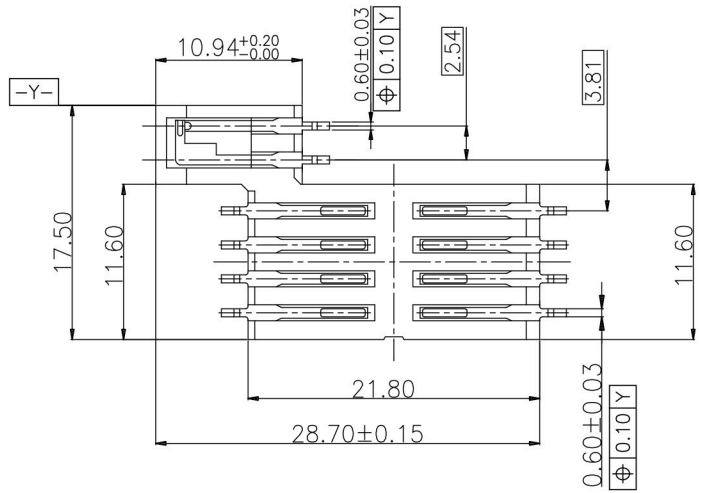

PCB Layout (component side view)
Recommend(Tolerance:±0.10)

NOTES:

- CURRENT RATING: 0.5AC/DC
- INSULATION RESISTANCE: 500MΩ MIN
- CONTACT RESISTANCE: 100mΩ MAX
- NORMAL CONTACT FORCE: 0.2N~0.6N
- DURABILITY: 100000 CYCLES
- OPERATING TEMPERATURE: -40℃~+85℃
- RoHS COMPLIANCE

ORDER INFORMATION

SMCR-83 10 - B K 3 0 T
① ② ③ ④ ⑤ ⑥ ⑦

- TYPE:
SMCR-83:SMART CARD CONNECTOR
- POSITIONS:
10:10 POSITIONS
- INSULATOR MATERIAL:
B: LCP
- INSULATOR COLOR:
K: BLACK
- CONTACT PLATING:
3: GOLD 5u"
- SHIELD PLATING:
0: NONE SHIELD
- PACKING
T: TRAY

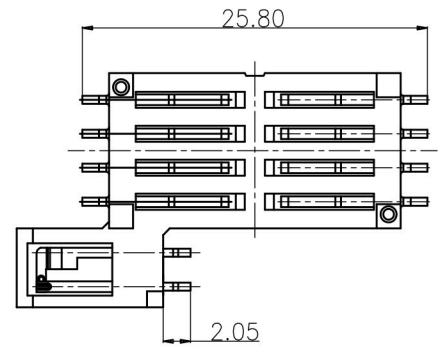
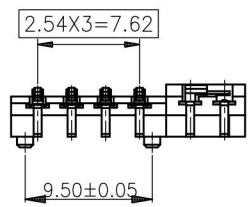
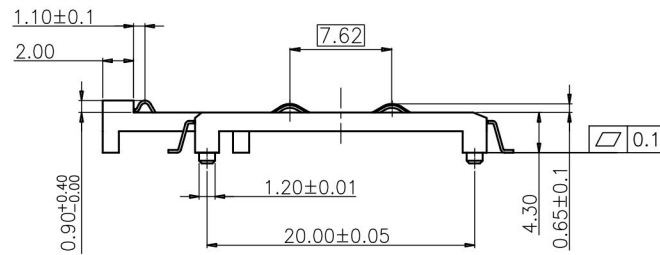

ITEM	NAME	Q'TY	DESCRIPTION
3	SWITH	1	PHOSPHOR BRONZE, GOLD 5u" MIN PLATING CONTACT AREA, TIN 80u" MIN PLATING SOLDER AREA, 50u" MIN PLATING UNDER OVERALL
2	CONTACT	10	PHOSPHOR BRONZE, GOLD 5u" MIN PLATING CONTACT AREA, TIN 80u" MIN PLATING SOLDER AREA, 50u" MIN PLATING UNDER OVERALL
1	HOUSING	1	LCP

GENERAL TOLERANCE X±0.50 .X±0.38 .XX±0.25 .XXX±0.15	ANGLE TOLERANCE X°±5.0° .X°±3.0° .XX°±2.0° .XXX°±1.0°	DRAWN <i>knighe</i>	DATE 03/10/15'	
MATERIAL SEE BOM		CHECKED	DATE	
FINISH SEE NOTES		APPROVED <i>River</i>		DATE 03/10/15'
SCALE N/A	UNIT mm	DRAWING NO. GT26-210426		SIZE A4 REV. A
SHEET 1 OF 1		NOTE BLACK, UL94 V-0		