

REV.	ECN. NO.	DESCRIPTION	ENG	DATE
A		INITIAL	DANIEL	2/18'14

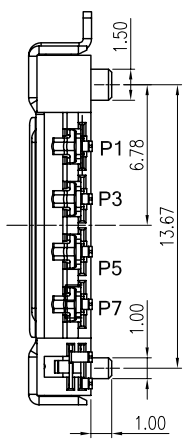
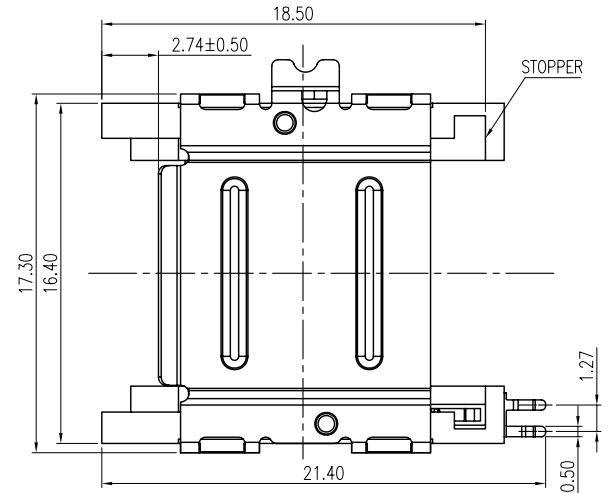
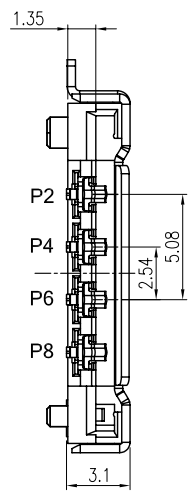

ORDER INFORMATION

SIMR- 3308 - B K X 2 T 01  
 ① ② ③④⑤⑥⑦

- CONNECTOR  
SIMR-33: SIM CARD CONNECTOR
- POSITIONS  
08: 8 POSITIONS
- INSULATOR MATERIAL  
B: LCP
- INSULATOR COLOR  
K: BLACK
- CONTACT PLATING  
1: GOLD FLASH  
8: 6u" GOLD PLATING  
5: 15u" GOLD PLATING
- SHIELD PLATING  
2: TIN PLATING
- PACKING  
T: TRAY

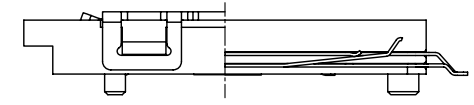
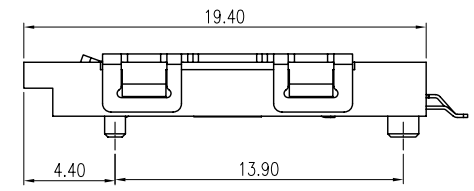
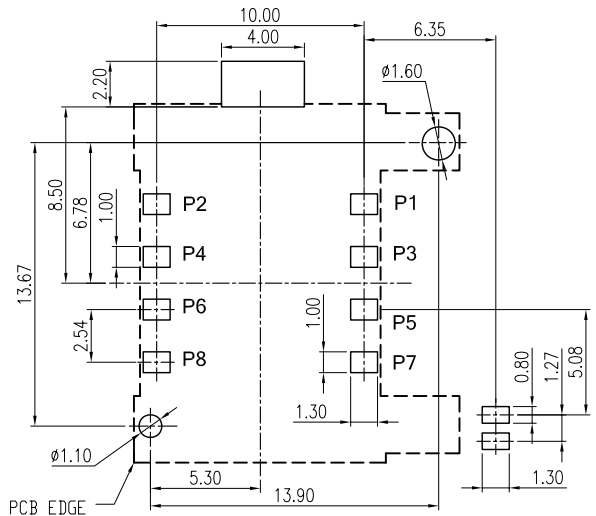

NC: NORMALLY CLOSED

NOTE:

Material  
 Contacts: Phosphor Bronze.  
 Plating: Selective gold on contact area, gold flash on solder tail, nickel under-plating overall.  
 Switch: Phosphor Bronze.  
 Plating: gold flash on contact and solder tail area both, nickel under-plating overall.  
 Insulation: Thermoplastic UL94V-0  
 Heatsink: SPTE  
 Plating: Tin Plating Steel

Electrical Characteristics  
 Number of contacts: 6 or 8 pins  
 Card ending switch: See Order information.  
 Contact resistance: 100 m ohms max.  
 Insulation resistance: >1000 megohms /500 VDC  
 Operating temperature: -25°C to +85°C  
 RoHS Compliant

Coplanarity of Solder tails to be within 0.12mm  
 Measurement point is solder tails tip.

RECOMMENDED PCB LAYOUT  
 TOLERANCE: ± 0.05

RoHS Compliant

5	HEATSINK	1	SPTE	0.40mm (TIN PLATING STEEL)
4	HOUSING	1	LCP	
3	SWITCH 1	1	C5191	0.15mm
2	SWITCH 2	1	C5191	0.15mm
1	CONTACT1	8	C5191	0.15mm
ITEM	NAME	Q'TY	DESCRIPTION	THICKNESS

GENERAL TOLERANCE	ANGLE TOLERANCE	DRAWN	DATE
X.±	X°±	DANIEL	02/18'14
.X±0.38	.X°±	DESIGN	DATE
.XX±0.25	.XX°±	DANIEL	02/18'14
.XXX±0.10	.XXX°±	CHECKED	DATE
MATL	SEE BOM	FINISH	SEE NOTES
SCALE	N/A	UNIT	mm
SHEET	1 OF 1	APPROVED	DATE

PRELIMINARY NOT RELEASED
<b>genesis</b> connected solutions
TITLE: SIM CARD READER SMT TYPE WITH HEATSINK
PART NUMBER: SIMR-3308-BKX2T01
DRAWING NO. GT23-250163

SIZE A4
REV. A