

PROPRIETARY INFORMATION
COMPANY CONFIDENTIAL

REV.	ECN. NO.	DESCRIPTION	ENG	DATE
X1		INITIAL	Hill	3/17/15"

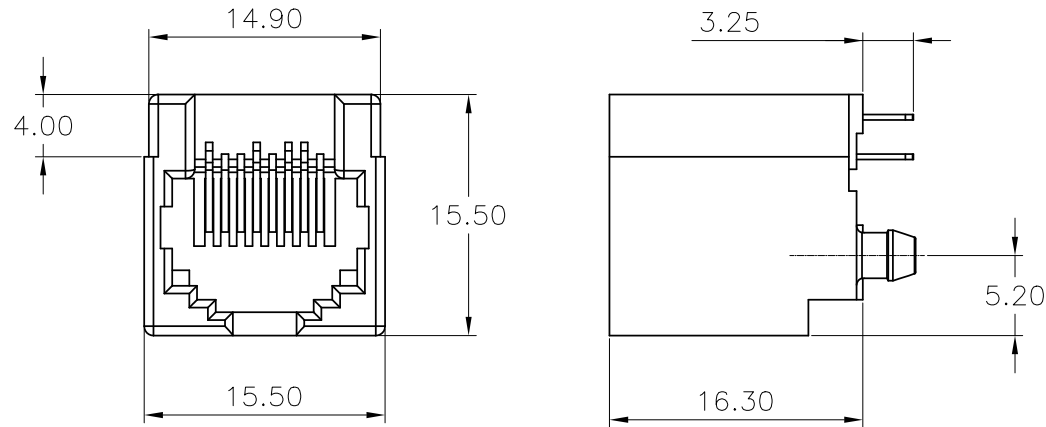

Notes:

- Materials:
 - Housing: Black Glass Filled Thermoplastic(UL94V-0)
 - RJ contacts: Phosphor Bronze
Finish: Selective gold plate see table
- Tolerances comply with EIA/TIA 568 dimension requirements
- Wave solder compatible for 260°C for 5 seconds
- UL approval Per DUXR2 & DUXR8

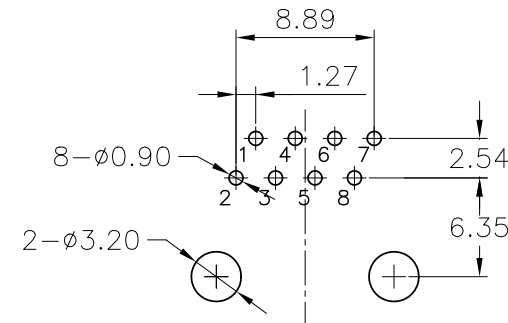

PC Board Layout Component Side Shown



MP45-W01E-60V-00N5	50 Micro Inches
MP45-W01E-60V-00N4	30 Micro Inches
MP45-W01E-60V-00N3	15 Micro Inches
MP45-W01E-60V-00N2	6 Micro Inches
MP45-W01E-60V-00N1	Flash
Part Number	RJ Contact Plating Thickness (Au)

GENERAL TOLERANCE	ANGLE TOLERANCE	DRAWN	DATE	GENESIS TECHNOLOGIES	
X.± 0.50	X'± 5.0'	Ryan	3/17/15"	TITLE: C6 TOP ENTRY PCB JACK	
.X± 0.38	.X'± 3.0'	CHECKED	DATE	PART NUMBER: MP45-W01E-60V-00NX	
.XX± 0.25	.XX'± 2.0'	Hill	3/17/15"	DRAWING NO. GT26-700332	
.XXX± 0.15	.XXX'± 1.0'	APPROVED	DATE	SIZE A4	REV. X1
MATL SEE BOM		Bryan	3/17/15"		
FINISH SEE BOM					
SCALE N/A	UNIT mm				
SHEET 1 OF 1					